

CANTER 2.0T

FE150E1

WIDE CAB



FE150E1

NOMINAL PAYLOAD	GVM	GCM	POWER	WHEELBASE	CODE
2.0t	4495kg	7995kg	148ps	3350mm	FE83PE4SRFAA

PERFORMANCE (Calculated – Paved Road)

Maximum Speed:	125km/h
Gradeability at Rated GVM:	64.6%
Gradeability at Rated GCM:	31.5%
Turning Circle (kerb to kerb):	12.0m

ENGINE

Mitsubishi 4D34-3AT3B Diesel (EPA98)

Configuration:	4 Cyl. In-line OHV
Type:	Turbocharged and Intercooled with Quick Heat Glow Plugs and Catalytic Converter
Displacement:	3907cc
Bore x Stroke:	104 x 115mm
Power (JIS Gross):	109kW (148ps) @ 2900 rpm
Torque (JIS Gross):	392Nm (289lb/ft) @ 1600 rpm
Maximum Engine Speed:	3400 rpm
Compression Ratio:	18.0:1
Oil Cooler:	Plate Type, Water Cooled

4D34-3AT3B

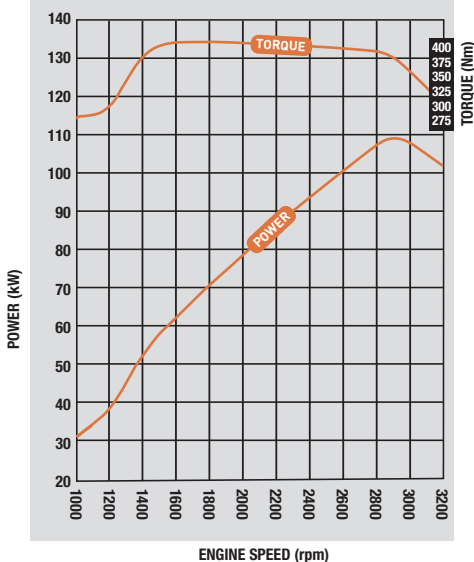

FUEL

Pump:	MD-TICS (pre-stroke control) In-line Type
Governor:	RED-III Electronic
Controls:	Key Operated Start/Fuel, Engine Idle and Engine Emergency Stop
Filtration:	Main Filter and Water Separator
Fuel Capacity:	100 Litres with Locking Fuel Cap
Air Cleaner:	Dry Paper Element with Vertical Intake

COOLING

Fan:	430mm dia. 8 Blades
Fan Drive:	Thermo Modulated
Radiator:	Corrugated Fin with Expansion Tank

ELECTRICAL

Voltage:	12V Negative Earth
Alternator Capacity:	12V-100 amp
Starter Capacity:	12V-3.0kW
Battery Capacity:	2 x 12V, 110Ah/20hr in Parallel
Headlamp:	2 x 55/60W Quartz Halogen

CLUTCH

Mitsubishi C4W30D

Disc Diameter:	300mm
Type:	Single Dry Plate
Operation:	Hydraulic with Direct Power Cylinder
Facing – Area:	Asbestos Free – 846cm ²

TRANSMISSION

Mitsubishi M035S5

No. of Speeds:	5 with In-Dash Gearshift Control
Synchromesh:	2nd–5th
Ratios – 1st:	5.380
– 2nd:	3.028
– 3rd:	1.700
– 4th:	1.000
– 5th:	0.722
– Rev.:	5.380
PTO Opening:	LH Side

PROPELLER SHAFT

Type:	P3
Universal Joint:	Needle Roller

FRONT AXLE

Type:	Reverse Elliot 'I' Beam
Design Capacity:	2300kg
Maximum Operating Capacity:	2300kg

REAR AXLE

Mitsubishi D033H

Type:	Full Floating Hypoid
Design Capacity:	3300kg
Maximum Operating Capacity:	3300kg
Ratio:	4.875:1

STEERING

Type:	Integral Power Assisted Ball and Nut
Ratio:	22.6:1
Steering Wheel:	400mm Urethane with Air Bag
Steering Column:	Tilt/Telescopic Adjustable with Lock

BRAKES

Type:	Vacuum Assisted Hydraulic Dual Circuit with ABS (anti-lock braking system) and Automatic Brake Adjustment
Size – Front:	320 x 75mm
– Rear:	320 x 75mm
Lining – Asbestos Free: Area/Swept –	2088/3017cm ²
Park Brake:	Transmission Mounted
Auxiliary:	Exhaust Brake
Vacuum Reservoir Cap:	4.0 Litres

FRONT SUSPENSION

Type:	Long Taper Leaf with Stabiliser Bar
Size:	1200 x 70 x 16mm-2 Leaves
Capacity at Ground:	1300kg ea.
Shock Absorbers:	Double Acting

REAR SUSPENSION

Type:	Semi-Elliptic Leaf with Stabiliser Bar
Size:	1250 x 70 x 11mm-5 Leaves 10mm-1
Auxiliary:	990 x 70 x 9mm-2 Leaves 8mm-4
Capacity at Ground:	2100kg ea.
Shock Absorbers:	Double Acting

CHASSIS

Type:	Reinforced Tapered Channel
Size:	193 x 60 x 6.0mm
Width:	753mm
Tensile Strength:	440 MPa

Refer to FUSO bodybuilder guidelines on web site www.mmzntruckdvw.co.nz before mounting a body or modifying the chassis.



WHEELS & TYRES

Wheel	– Type:	7, Single Piece Disc
	– Size:	16 x 5.5K-115-9t
	– Stud Pattern:	5 x 208mm PCD
Tyre	– Size:	205/85R16LT 117/115L
Spare Tyre Carrier:		Provided

KERB WEIGHT (kg – estimated)

Front	Rear	Total
1590	700	2290

Includes coolant, oils, spare wheel, tools and 20 litres fuel.

DIMENSIONS (mm)

Wheel Base:	3350mm
Overall Length:	6015mm
Cab to Axle:	2825mm
Cab to End of Frame:	4305mm
Rear Overhang:	1480mm
Overall Height:	2185mm
Overall Width:	1995mm
Chassis Height at Rear Axle:	770mm

CAB FEATURES

All Steel Forward Control
(Complies with European Crash Standard ECE R29)

Type: Manual Tilt 45°
 Mounting: Hydroelastic 4 Point
 Colour: Natural White
 Interior: Fully Trimmed
 Windscreen: Laminated Tinted
 Windscreen Wipers: 2 Speed – Intermittent Cycle with Integrated Washer Nozzles
 Rear Vision Mirrors: 1 x Internal
 2 x External Convex – Heated
 Seating Capacity: 3
 Seat Belts: 2 ELR Lap Sash, 1 Lap
 Seat Belt Pre-Tensioner on Driver's Side

Seats Driver: – 228mm Sliding
 – 47° Reclining
 – Headrest and Fabric Trim
 LH: – Flat Folding, 2 Passenger Bench
 Type with Reclining Adjustment
 – LH Headrest and Fabric Trim

INSTRUMENTS

Gauges:

- Speedometer with Odometer and Dual Tripmeter
- Tachometer
- Fuel Level, Water Temperature

Warning Lamps:

- High Beam
- Turn Signal/Hazard Warning
- Park Brake/Brake Dual Circuit
- Exhaust Brake, Low Vacuum, ABS
- Engine Pre-Heat
- Alternator
- Low Oil Pressure
- Engine Control (ECU)
- Heated Mirrors
- SRS Air Bag

CAB EQUIPMENT

- Driver's Air Bag and Seat Belt Pre-Tensioner
- Electric Windows
- Keyless Central Locking
- Door Side Impact Beams
- Tinted Side and Rear Glass
- Heater Demister/Air Conditioning
- AM/FM ETR Radio with CD Player and Digital Clock
- Dash Storage Tray, 2 DIN Glove Compartment
- RH Overhead, Map and Door Storage Pockets
- Floor Console, LH Seat Back Trays
- Cup Holders (2)
- Coat Hooks
- Interior Sun Visors
- Fluorescent Cabin Lamp
- Interior Dome Lamp with Delay Function
- Cigar Lighter
- Engine Access Panel
- Roof Mounting Points (max. static load 50kg)
- Electric Horn
- Reverse Warning Buzzer
- Toolkit

Warranty

36 months/100,000km (whichever comes first)

**Subject to the conditions outlined in the New Vehicle Warranty leaflet*

CANTER 2.0T FE150E1

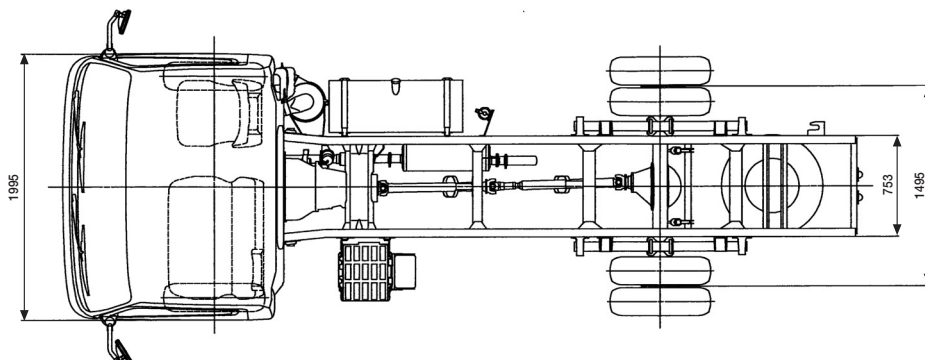
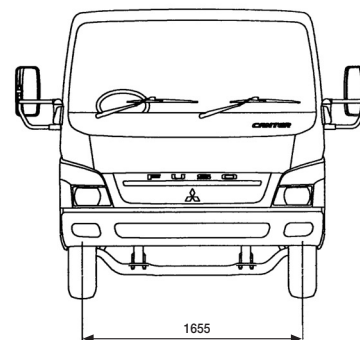
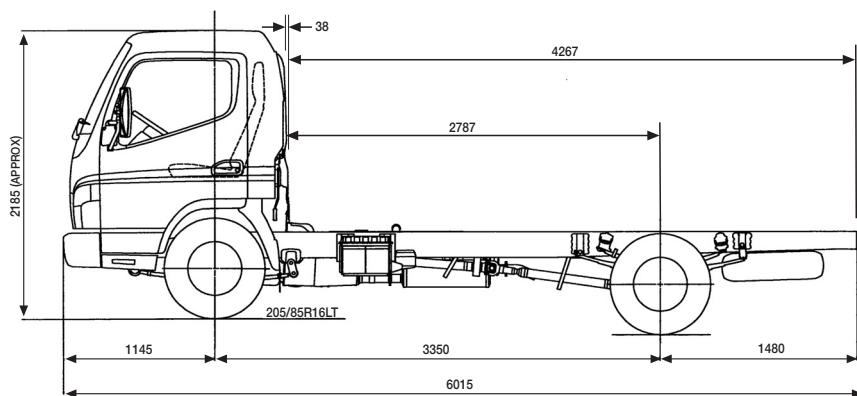

FUSO

WWW.FUSO.CO.NZ